

ATR 2024

Australasian Transport Research Forum

Stronger Together:
Integrating Land Use
and
Sustainable Transport

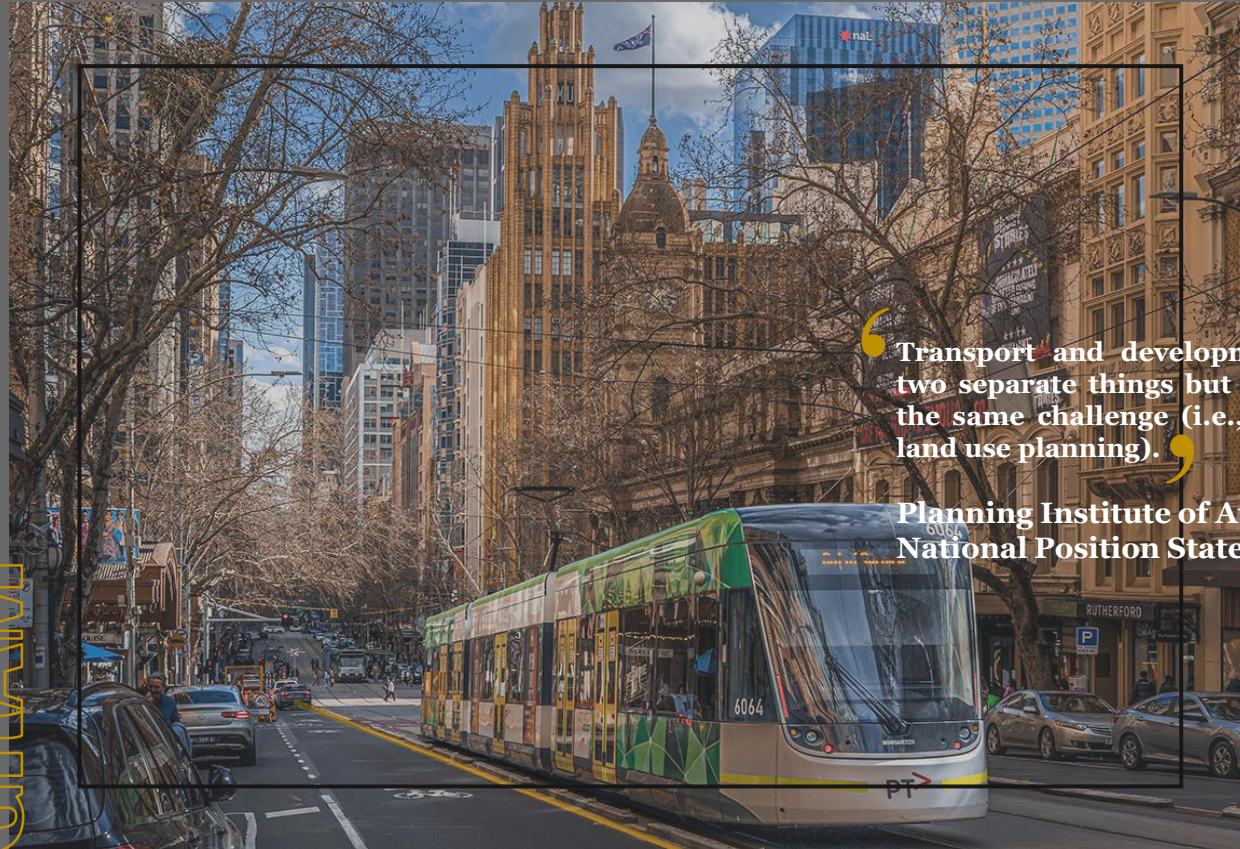

Transport and development are not two separate things but two facets of the same challenge (i.e., transport is land use planning).

Planning Institute of Australia
National Position Statement 2007

PROGRAM

Welcome

On behalf of the Local Organising Committee, I warmly welcome you to the 2024 ATRF conference in Melbourne! This year's program offers thought-provoking sessions, interactive PhD workshops, engaging debates, and an impressive line-up of speakers, covering a wide range of topics—from land use and transport integration to data-driven solutions.

This conference is made possible by the generous support of our sponsors and the dedication of many behind the scenes. Let us seize this opportunity to collaborate, innovate, and inspire one another.

Thank you for being a part of ATRF 2024—I hope you enjoy the forum and your time here in Melbourne.



Assoc Prof Liton Kamruzzaman
Chair
Local Organising Committee

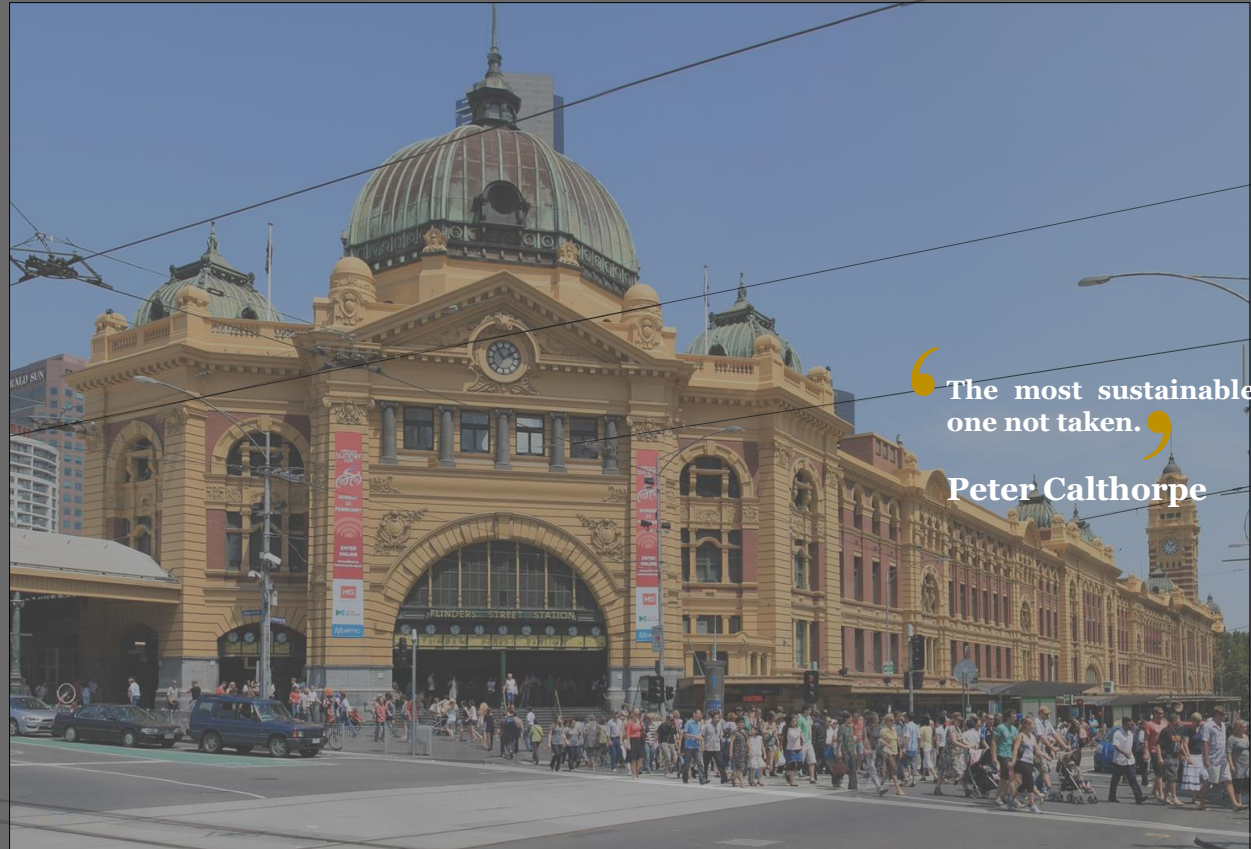

“The most sustainable trip is the one not taken.”
Peter Calthorpe

ATRF 2024

**Monash College
750 Collins St**

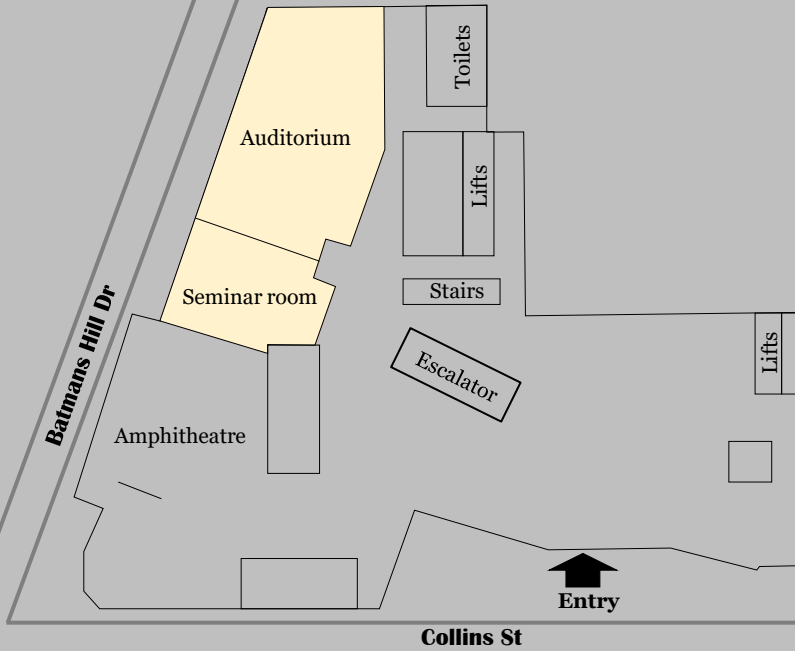

Level 2 FLOOR PLAN

VENUE

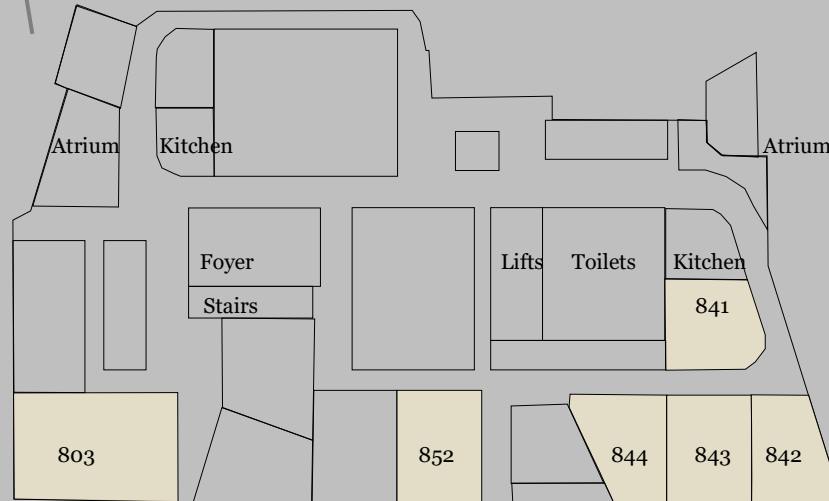

**Level 8 FLOOR PLAN
Not to scale**



Hosts



MONASH
University

MONASH
CIVIL
ENGINEERING



Department
of Transport
and Planning

Gold



Silver



Australian Government

Department of Infrastructure, Transport,
Regional Development, Communications and the Arts
Bureau of Infrastructure and Transport Research Economics

Bronze



SPONSORS



Welcome reception



Keynote session



Lindsay Oxlad Consulting

Concurrent session



Satchel



Dinner



SPONSORS

**Tuesday
26 November**

- 8.45am – 3.00pm Technical Tour: Melbourne Metro – ANZAC Station and Grattan St Urban Realm
Coordinator: Dr Eric Keys, RMIT University
- 10.30am – 1.00pm Academic-Practitioner Dialogue on Transport Modelling
Room 803 Chair: Prof Le Hai Vu, Monash University
- 11.45am – 5.00pm Technical Tour: Suburban Rail Loop – Briefing and Burwood Site Visit
Coordinator: Mr Knowles Tivendale, Movement & Place Consulting
- 1.00pm – 2.00pm Lunch and Networking
Level 8 Foyer
- 2.00pm – 5.00pm Inaugural Student Research Symposium
Room 841 Chair: Assoc Prof Nan Zheng, Monash University

PROGRAM

Wednesday 27 November

8.00am – 5.00pm
Level 2 Foyer

Registration Desk Open

8.00am – 9.00am
Level 2 Foyer

Arrival Tea/Coffee & Networking

9.00am – 10.40am
Level 2 Auditorium

ATRF OPENING – sponsored by SIDRA SOLUTIONS
Chair: Prof Graham Currie, Monash University

Acknowledgement of Country & Opening Speech
Prof Chris Davies, Deputy Dean Operations, Faculty of Engineering, Monash University

Housekeeping
Assoc Prof Liton Kamruzzaman, Monash University

KEYNOTE 1 | Embracing indigenous knowledge in transport and land use planning
Dr Mandy Nicholson, University of Melbourne

KEYNOTE 2 | Transport integration and innovation: Supporting Victoria's precinct, place and housing vision
Ms Natalie Reiter, Deputy Secretary Strategy and Precincts, Department of Transport and Planning

10.40am – 11.00am
Level 8 Foyer

Morning Tea

PROGRAM

CONCURRENT SESSION 1

11.00am – 12.20pm

**Wednesday
27 November**

Session 1A Public transport Room 841	Session 1B First-mile / last-mile Room 842	Session 1C Travel behaviour Room 843	Session 1D Travel demand modelling Room 844	Session 1E Transport & land use Room 852
Chair Prof John Nelson	Chair Assoc Prof Selby Coxon	Chair Mr Mark Davis	Chair Dr Shams Yasmin	Chair Prof Pascal Perez
Examining the impact of Covid-19 vaccination on public transport consumption: Evidence from Australia's HILDA dataset [8] Md Shahin*, Milad Ghasri & A Abbasi	Investigating shared e-scooter travel and public transport service level in Melbourne [31] Graham Currie*, Alexa Delbosc, Ryan Cox, Mahesha Jayawardhena & James Reynolds	Modelling an inter-city Summer Olympics & Paralympics: The difficult issues and how they may be resolved [42] Mohammad R Hossain*, Matthew Burke, Abraham Leung & Jamie Spencer	A pool-based approach to population synthesis in transport modeling [51] Duc Minh La* & Hai Vu	How worker residential migration shapes urban internal structure and commuting changes in Melbourne [9] Tiebei Li* & Jago Dodson
Practical walking transfers in public transport routing [21] Abdallah Abuaisa*, Mark Wallace, Daniel Harabor & Bojie Shen	A survey of self-reported shared e-scooter travel patterns related to public transport in Melbourne [39] Mahesha Jayawardhena*, Alexa Delbosc, Graham Currie, & Geoff Rose	The 2022 ACT & Queanbeyan Household Travel Survey findings and use in developing the Canberra Strategic Transport Model [89] James Ramsey*	Train carriage passenger count estimation from ticketing data using a hybrid framework combining heuristics and machine learning models: Proof of concept [57] Saeed Mohammadian, Zuduo Zheng* & Tristan Miles	Exploring the association between housing type and travel behaviour: A focus on public transport use in Melbourne [88] Mehdi Alidadi*, Chris De Gruyter, Afshin Jafari & Sarah Foster
The impact of spatial resolution on public transport accessibility analyses [74] Yanda Qu*, Graham Currie & Geoffrey Webb	Active and micromobility to bus: The next step in low emission journeys? [77] Robbie Napper*, Andres Rodriguez-Ruiz, Selby Coxon & Niels van Oort	How Greater Brisbane's 'four types of commuters' were distributed from a spatial and gender perspective in 2021 [128] David Hayward* & Harry Wilson	High-performance route choice set generation on large networks [115] Jake Moss*, Pedro Camargo, Christina de Freitas & Renata Imai	Exploring the effects of private autonomous vehicles on residential relocation choice [99] Allan Pimenta*, Liton Kamruzzaman & Graham Currie
A link-based approach for measuring walking accessibility [6] Zheng Liang*, Hong Lo, Ka Fai Ng & Kay Axhausen	Investigating the role of micro-mobility in first mile last mile transport [127] Khor Yi Chien, Susi Susilawati* & Hamza Zubair	Transport multi-mode choice prediction using a hybrid multi-output regression modelling [48] Tuo Mao*, Adriana-Simona Mihaita & Yuming Ou	Road network pricing models for travel demand management: Australian perspective [118] Tariq Munir*, Hussein Dia, Sajjad Shafiei & Hadi Ghaderi	Towards a desired neighbourhood: Actual vs. desired urban form [121] Sharmina Haque*, Liton Kamruzzaman & Jenny Zhou

PROGRAM

* Presenting author

12.20pm – 1.20pm
Level 8 Foyer

Lunch

1.20pm – 2.20pm
Level 2 Auditorium

KEYNOTE 3 | Opportunities in Australia's infrastructure pipeline to drive more sustainable outcomes
Speaker: Mr Adam Copp, Chief Executive Officer of Infrastructure Australia

Chair: Dr Hulya Gilbert, La Trobe University

2.20pm – 2.30pm

Room change

2.30pm – 3.30pm

CONCURRENT SESSION 2 – sponsored by Queensland University of Technology (QUT)

Session 2A
Public transport
Room 841

Session 2B
Active transport
Room 842

Session 2C
Travel behaviour
Room 843

Session 2D
Traffic safety
Room 844

Session 2E
Transport & land use
Room 852

Chair
Dr Subeh Chowdhury

Chair
Assoc Prof Ben Beck

Chair
Dr Susi Susilawati

Chair
Mr Ian Hopkins

Chair
Dr Eric Keys

Measuring and incorporating a wider set of bus priority benefits in strategic modelling [104] Daniel Veryard*, Nancye Ng, Stuart Donovan, Zachary Gray, Haoang Li, Cameron Reid & Azim Bhutta

What's in a bike lane? Bike lane provision and micro-mobility rider behaviour [55] Alexa Delbosc*, Finlay Esler, Angus Mitchell, Aleksandar Naumoski & Constantine Halamantaris

The uptake of advanced vehicle technologies in household vehicles: An examining of joint choices in the fuel types and connected and automated vehicle features [35] Heshani Rupasinghe, Shimul M M Haque & Shams Yasmin*

Design considerations and efficacy of raised safety platforms in urban traffic management [82] Fahimeh Golbabaie*, Alexander Paz, Wahi Rabbani, Zeke Ahern & Simon Denman

Assessing the effects of land use patterns on the performance of mobility hubs in the Greater Melbourne Area [131] Shaoyan Zou*, Allan Pimenta & Liton Kamruzzaman

e-RoS: An exact multiple recharging stations rostering for electric bus fleet on a bus network [102] Dicky S Gozali*, Paul Corry & Ashish Bhaskar

Assessing the potential to increase bicycle access to train stations [70] Punthila Jayaratne, Geoff Rose* & Marilyn Johnson

Australian public perceptions of fully automated vehicles [43] Yilun Chen*, Shah K Khan, Nirajan Shiwakoti & Peter Stasinopoulos

Integrating machine learning and econometric models for estimating crash frequency by severity using traffic conflicts [37] Fizza Hussain & Shimul M M Haque*

Should we have 'pop-up' bikeways? Insights from Brisbane's CityLink Cycleway Trial [123] Abraham Leung*, Matthew Burke & Brendan O'Keefe

Comparison of OLS, GWR, MGWR, and Random Forest models for predicting bus commuter trips [28] Sekhar Somenahalli*

Bike lane implementation prioritization towards connectivity and reliability: A case study on Metro Manila [116] Simon A Lorenzo*

Mode choice in the era of driverless cars: Melbourne CBD car commuters [62] Fuad Huda*, Graham Currie & Liton Kamruzzaman

Understanding bridge strikes: A Melbourne tram network case study [40] James Reynolds*, Joshua de Waard & Graham Currie

Measuring use of the street space in central city areas [17] Chris De Gruyter*, L Davies, X Li, A Jafari, A Yacoubian & M Amati

**Wednesday
27 November**

PROGRAM

**Wednesday
27 November**

3.30pm – 4.00pm
Level 8 Foyer

Afternoon tea

4.00pm – 5.00pm
Level 2 Auditorium

KEYNOTE 4 – sponsored by LINDSAY OXLAD CONSULTING
Chair: Mr Lindsay Oxlad, Lindsay Oxlad Consulting

Driving positive urban outcomes: how integrating land use and transport planning makes a difference
Speaker: Ms Emma Riley, President, Planning Institute of Australia

5.00pm – 7.00pm
Level 2 Foyer

WELCOME RECEPTION – sponsored by MATRIX TRAFFIC AND TRANSPORT DATA
Chair: Prof Michael Kennedy, Monash University

Welcome speech: Mr Marty Prowse, CEO, Matrix Traffic and Transport Data

PROGRAM

**Thursday
28 November**

8.00am – 5.00pm
Level 2 Foyer

Registration Desk Open

8.00am – 9.00am
Level 2 Foyer

Arrival Tea/Coffee & Networking

9.00am – 10.30am
Level 2 Auditorium

SPOTLIGHT DIALOGUE & KEYNOTE 5
Moderator: Prof Geoff Rose, Monash University

Advancing integrated transport and land use planning

Speakers:

Ms Jessie Wright, Executive Director Strategic Planning, Department of Transport and Planning

Dr Allison Stewart, Division General Manager, Victoria, Mott MacDonald

Dr Jennifer Kent, University of Sydney

Assoc Prof Niels van Oort, TU Delft

10.30am – 11.00am
Level 8 Foyer

Morning Tea

PROGRAM

11.00am – 12.20pm

**Thursday
28 November**

CONCURRENT SESSION 3

Session 3A
Public transport
Room 841

Chair
Mr Peter Kartsidimas

Spatial discrepancies of public transport utilisation by parents in the Greater Melbourne Area [45] **Ulfah A Rahmah***, **Alexa Delbosc** & **Liton Kamruzzaman**

Exploring factors influencing perceived personal safety of female public transport users an effective intervention strategies [54] **Ruman Sarker***, **Lisa Trang** & **Graham Currie**

Assessing accessibility to healthcare facilities with public transport: A focus on older adults [111] **Nikhil Chand***, **Afshin Jafari**, **Dhirendra Singh**, **Lewi Stone** & **Mahdi Jalili**

Factors affecting public transport use amongst Melbourne adolescents [5] **Maryam Jafari**, **Alexa Delbosc*** & **Graham Currie**

Session 3B
E-scooters
Room 842

Chair
Dr James Reynolds

Payment class and usage behaviour of shared e-scooter riders [27] **Michael Vincent*** & **Geoff Rose**

Community views on legalising e-scooters: Insights from a Sydney case study [58] **Stephen Greaves***, **Matthew Beck**, **Geoff Rose** & **Melanie Crane**

Personal e-scooter ownership and use: Perspectives from New Zealand [11] **Stephen Greaves*** & **Ferdinand Balfoort**

Micromobility and events: Scale, operations and impacts, and the research agenda [41] **Hanieh Hashemi***, **Matthew Burke** & **Abraham Leung**

Session 3C
Travel behaviour
Room 843

Chair
Mr Bruce Johnson

Travel-based multitasking reframed? A latent class cluster analysis of travel time use styles [66] **Ana L S de Sa*** & **Patricia Lavieri**

Development of a national database for land use-based trip and parking generation surveys: Challenges and opportunities [80] **Supun Perera*** & **Michael Bell**

Effects of within-trip subjective experiences on travel satisfaction and travel mode choice: A conceptual framework [101] **Tommy Lim***, **Jason Thompson**, **Lauren Pearson**, **Joanne Caldwell** & **Ben Beck**

User preferences for on-demand transport in Melbourne: Insights from stated preference surveys [94] **Sohani Liyanage*** & **Hussein Dia**

Session 3D
Traffic safety
Room 844

Chair
Mr Michael Nieuwesteeg

Improving road safety? A personal story of change [61] **Eric Keys***

The safety benefits of 40 km/h speed limits on local roads [67] **Shaoyan Zou*** & **Alexa Delbosc**

Understanding the effects of speed limit reduction on community perception and driver behaviour: A case study of the Great Ocean Road [91] **Ashim Debnath*** & **Wonmongo Soro**

Cross-country policy comparison of 30 km/h speed limits [97] **Lauren Pearson***, **Megan Oakey**, **Breanna Nelson**, **Shazya Karmali**, **Mojgan Karbakhsh** & **Ben Beck**

Session 3E
Traffic modelling
Room 852

Chair
Assoc Prof Nan Zheng

Solving discrete network design problems using repairing path flows [20] **Ali Davoodi***, **Mark Wallace**, **Daniel Harabor** & **Dong Ngoduy**

Game-theoretic modelling of integrated longitudinal and lateral driving behaviours [26] **Zhaohan Wang***, **Mohsen Ramezani** & **David Levinson**

Inferring lane-level topology of signalised intersections from aerial imagery and OpenStreetMap using deep learning [68] **Hugo Nilsson*** & **Rachid Oucheikh**

Happy birthday induced demand! [71] **Graham Mounsey***

PROGRAM

Thursday 28 November

12.20pm – 1.20pm
Level 8 Foyer

Lunch

12.20pm – 1.20pm
Room 803

LUNCH TIME YOUTH PANEL
Moderator: Dr Hulya Gilbert, La Trobe University

Navigating tomorrow's transport: Insights from youth

1.20pm – 2.20pm
Level 2 Auditorium

DEBATE: Will high speed rail ever leave the station in Australia?
Moderator: Prof Matthew Burke, Griffith University

Debaters:

Prof David A. Hensher AM, ITLS University of Sydney

Ms Marion Terrill, Independent transport and infrastructure expert

Assoc Prof Niels van Oort, TU Delft

Dr Marcus Spiller, Principal & Partner, SGS Economics and Planning

2.20pm – 2.30pm

Room change

PROGRAM

**Thursday
28 November**

2.30pm – 3.30pm

PROGRAM

CONCURRENT SESSION 4

Session 4A
Public transport
Room 841

Chair
Mr Chris Loader

What transport problems can high speed rail address and what opportunities can it enable? A route geography approach [133] **Phil Potterton***

Design considerations for last mile connectivity in populous urban areas with a case study from an Indian city [117] **Dhruv Sorathiya, Aishwarya Omar, Shibsankar Maity, Siddharth Mehta, Aditya Paranjape*, Souvik Barat & Vinay Kulkarni**

Optimizing timetable schedules considering non-traffic hour maintenance window on urban rail transit systems [23] **Yaochen Ma*, Hai Wang & Hai Yang**

Session 4B
Active transport
Room 842

Chair
Prof Stephen Greaves

A review to unpacking the design and characteristics of e-bike financial incentives and their impact on e-bike adoption [125] **Hossein Nosratzadeh*, Debjit Bhowmick, Ana B R Carmona, Jason Thomson, Thao Thai, Lauren Pearson & Ben Beck**

E-bike trial in Geelong, Victoria: An analysis of usage and travel patterns [103] **Ashim Debnath*, Wonmongo Soro & Liton Kamruzzaman**

Cycling legacy from major events: Conceptualising and planning cycling impacts of Brisbane 2032 [76] **Niloofer D Samani*, Matthew Burke, Kelly Bertolaccini & Elaine Yang**

Session 4C
Travel behaviour
Room 843

Chair
Dr Taru Jain

Exploring the car-free lifestyle: Study of urban residents in Saudi Arabia. Case study: Al-Ahsa city [4] **Sufian Almubarak***

The new normal: Leveraging opensource economic databases to inform consumer behaviour and safety across Sydney's tolled network [34] **Gregory Aouad*, Kasun Wijayaratna & Vinayak Dixit**

Short-trips travel behaviour of young adults in Greater Melbourne: Bicycles versus cars [124] **Ana B R Carmona*, Lauren Pearson, Jason Thomson, Jennifer L Kent, Thao Thai & Ben Beck**

Session 4D
Intelligent transport
Room 844

Chair
Prof Sara Moridpour

A platoon-based cooperative merging ecological control framework under connected environment [paper 14] **Sheng Yue*, Fang Zong, Takao Dantsuji & Dong Ngoduy**

Map-matching large streams of vehicle GPS data into bespoke networks [53] **Pedro Camargo* & Renata Imai**

Retiring meters: A roadmap to encourage wider adoption of parking apps [113] **Mohammad Mahdi Ahmadian*, Prithvi Beeramoole, Douglas Baker, Paula Macias & Alexander Paz**

Session 4E
Traffic modelling
Room 852

Chair
Dr Afshin Jafari

Impact of electric vehicles using transport and energy modelling [49] **Minwei Chen, Tuo Mao*, Adriana-Simona Mihaita, Yuming Ou & Bo Du**

Network free flow speed calibration in MATSim with Google API data: A Melbourne study [72] **Sapan Tiwari*, Chengqi Lu & Afshin Jafari**

Modelling link-level bike riding volumes in Greater Melbourne [90] **Debjit Bhowmick*, Tanapon Lilasathapornkit, Meead Saberi, Sachth Seneviratne, Trisalyn Nelson, Kerry Nice & Ben Beck**

Thursday 28 November

PROGRAM

3.30pm – 4.00pm
Level 8 Foyer

Afternoon tea

4.00pm – 5.20pm

CONCURRENT SESSION 5

Session 5A
Travel demand modelling
Room 841

Session 5B
Active transport
Room 842

Session 5C
Transport economics
Room 843

Session 5D
Intelligent transport
Room 844

Session 5E
Traffic modelling
Room 852

Chair
Prof David A. Hensher AM

Chair
Dr Chris De Gruyter

Chair
Dr Marcia Keegan

Chair
Dr Kai Li Lim

Chair
Prof Taha Rashidi

Calibrating strategic models for congested networks [86] **Paul van den Bos***

Exploring cyclists' perceptions of safety and comfort: A machine learning approach to enhancing urban cycling environments [38] **Lurong Xu***, **Shuli Luo**, **Alexa Delbosc** & **Steve O'Hern**

Ex-post evaluation: Considerations of its application to transport projects in NSW [60] **Vartguess Markarian***

Automated mobility for elderly and people with disability [18] **Somayah Asiri***, **Erik Van Vulpen** & **Huawei Tu**

A hybrid neural network for real-time OD demand calibration under disruptions [22] **Takao Dantsuji***, **Dong Ngoduy**, **Ziyuan Pu**, **Seunghyeon Lee** & **Hai Vu**

Modelling the impact of road infrastructure on cycling moving speed [119] **Afshin Jafari***, **Dhirendra Singh** & **Billie Giles-Corti**

Associations of utilitarian cycling with destination and street connectivity assessed within multiple buffers [50] **Firas Mohamed***, **Manoj Chandrabose**, **Neville Owen** & **Takemi Sugiyama**

Addressing current challenges in the economic appraisal of active transport grant programs [95] **Lee Jollow***

Designing the future of mobility: Accessible autonomous vehicles for enhancing inclusion and opportunities for people with disabilities [81] **Fahimeh Golbabaei***, **James Dwyer**, **Rafael Gomez**, **Andrew Peterson**, **Kevin Cocks**, **Alexander Bubke** & **Alexander Paz**

A decentralized urban traffic signal control integrating traffic responsive framework with a group-based signal policy [98] **Tamojit Ghosh***, **Lelitha D Vanajakshi**, **Shimul M M Haque** & **Ashish Bhaskar**

Investigate the travel behaviour of e-scooter riders in Melbourne: A spatiotemporal analysis with PCA [122] **Teng Li***, **Zhuo Chen** & **Alexa Delbosc**

Riding beyond obstacles: The role of cycling experience in perception of barriers [112] **Tayebeh Saghapour***, **Afshin Jafari** & **Steve Pemberton**

Willingness-to-pay values for safety in cars: What they include and exclude [100] **Mark Harvey*** & **Sayan Chakrabarty**

Using personas to understand potential uptake of tourism MaaS bundle offers in regional destinations [129] **Abraham Leung*** & **Paul Scott**

State-wide route choice models [75] **Jan Zill*** & **Pedro Camargo**

Shared micro-mobility route choice analysis [126] **Piek Y Tan** & **Susi Susilawati***

Congestion pricing in multi-modal networks: An application of deep reinforcement learning [92] **Nasser Parishad*** & **Mehmet Yildirimoglu**

**Thursday
28 November**

6.00pm – 7.00pm
Q-Events

Pre-dinner drinks
123 Queen St, Melbourne, VIC 3000

Entertainment: Acoustic Duo

7.00pm – 10.00pm
Q-Events

CONFERENCE DINNER – sponsored by AURIN
123 Queen St, Melbourne, VIC 3000
Chair: Mr Michael Hopkins, CEO, National Transport Commission

KEYNOTE 6

The Missing Link - Transport emission modelling and regional climate projections
Speaker: Prof Pascal Perez, Director, AURIN

KEYNOTE 7

The imperative and opportunities for transport and land use integration
Speaker: Dr Jonathan Spear, CEO, Infrastructure Victoria

PROGRAM

Friday 29 November

8.00am – 5.00pm Level 2 Foyer	Registration Desk Open
8.00am – 9.00am Level 2 Foyer	Arrival Tea/Coffee & Networking
9.00am – 10.00am Level 2 Auditorium	KEYNOTE 8 Chair: Dr Taru Jain, Department of Transport and Planning Unpacking the connection: built environment, travel behaviour and attitudes Speaker: Assoc Prof Jonas De Vos, University College London
10.00am – 10.10am	Room change
10.00am – 11.00am	Technical Tour: Transport Operations Centre Coordinator: Dr Rumana Sarker, Monash University

PROGRAM

10.10am – 11.10pm

**Friday
29 November**

PROGRAM

CONCURRENT SESSION 6

Session 6A
Public transport
Room 841

Chair
Mr Wes Mayne

Measuring transit quality for major events in regional centres: were the Commonwealth Games 'on track'? [32] Antonio Puey, James Reynolds* & Graham Currie

An investigation of regional public transport spend in Australia [47] Thiranjaya Kandanaarachchi & John Nelson*

Improving Melbourne's tram services through APC and Mobile GPS data analysis: A professional practice paper [33] Tianwei Yin* & Ian Hopkins

Session 6B
Health & Environment
Room 842

Chair
Dr Ian Woodcock

Strategies and technologies for mitigating airborne transmission risks in public transportation [83] Fahimeh Golbabaie*, Alexander Paz, Saeed Jaydarifard & Lidia Morawska

Systematic review & meta-analysis of interventions to support modal shift to active travel [120] Lauren Pearson*, Matthew Page, Robyn Gerhard, Nyssa Clarke & Ben Beck

Neighbourhood planning approaches to net zero transport [132] Liton Kamruzzaman*, Graham Currie, Le Hai Vu, Eric Miller & Roger Vickerman

Session 6C
Traffic safety
Room 843

Chair
Dr Wynita Griggs

Improving the safety of young pedestrians using educational videos [29] Md Shohel Parvez, Shanmuga Sundaram Kanthaswamy, Srepranesh Shanmuga Sundaram, Richard Tay & Sara Moridpour*

Commonly used and omitted factors in pedestrian crash data modelling: A synthesis of the literature [114] Sadia Afroza*, Kazem Ghabraie, Amir Sobhani & Ashim Debnath

Factors considered by light vehicle drivers when changing lanes around heavy vehicles [69] Sajani Siriwardene*, Mahmud Ashraf & Ashim Debnath

Session 6D
Intelligent transport
Room 844

Chair
Dr Neema Nassir

A continuous operation strategy for shared autonomous vehicles based on dynamic wireless charging [63] Yunlong Wang*, Minh Kieu, Zhihao Zhang & Prakash Ranjitkar

Parking relocation preferences for private autonomous vehicle users [93] Allan Pimenta*, Liton Kamruzzaman & Graham Currie

Evolution of charging behaviours in Australian EV drivers: An empirical study [109] Kai Li Lim*, Thara Philip, Andrea La Nauze & Jake Whitehead

Session 6E
Transport & land use
Room 852

Chair
Mr Tim Bryant

Melbourne's consolidation: Integrated planning in practice [25] Eric Keys*, Chris DeGruyter & Steve Pemberton

Evaluation of Australian electric vehicle charging policies through a social justice perspective [59] Isrrah Malabanan*, Patricia Lavieri & Iderlina Mateo-Babiano

Transport development stages in Australian cities: An analytical understanding of density and mode shares [106] Alex Blackett*, Phillip Shelton, Sarah Dewbery & David Hayward

**Friday
29 November**

11.10am – 11.40am
Level 8 Foyer

Morning tea

11.40am – 12.40pm

CONCURRENT SESSION 7

Session 7B
Health & Environment
Room 842

Session 7C
Traffic safety
Room 843

Session 7D
Intelligent transport
Room 844

Session 7E
Transport & land use
Room 852

Chair
Dr Peter Tisato

Chair
Assoc Prof Ashim Debnath

Chair
Dr Emily Moylan

Chair
Dr Páraic Carroll

Navigating the golden years: Exploring multimodal transport and activity spaces of older adults within transit-oriented urban environments in Sydney, Australia [64] **Jialing Xie* & Ian Woodcock**

Disparities in road safety outcomes between Indigenous and non-Indigenous Australians [130] **Ali Soltani, Andrew Allan* & Jaquelyne Hughes**

Incident reporting for autonomous shuttles via LLMs: Eglinton case study [52] **Xiangrui Kong* & Thomas Bräunl**

Spatial accessibility for women: A systematic literature review [46] **Ulfah Aliifah Rahmah*, Alexa Delbosc & Liton Kamruzzaman**

A framework for exploring links between social capital and community transport design and delivery [7] **Sandra Wilson*, Graham Currie & Alexa Delbosc**

Investigating the impact of surrounding vehicles on merging location choice in work zones [65] **Tharindu Ranawaka*, Huw Davies, Christophe Bastien & Ashim Debnath**

Developing a Brisbane 2032 MaaS Solution: learnings from a narrative review [73] **Behzad Ranjbarnia*, Matthew Burke, Abraham Leung & Paul Scott**

Exploring road users' view towards the concept of sharing road space: A case study of Australia and the UK [56] **Amrit Ghimire*, Nhu Nguyen, William Payre, Stewart Birrell & Ashim Debnath**

Diving the depth of children's everyday mobilities: A multilevel perspective [110] **Hulya Gilbert***

Analysing the impact of raised platforms for motor-cycle safety [107] **Zeke Ahern*, Simon Denman, Wahi Rabbani & Alexander Paz**

Optimizing the initialization of fleet deployment for mobility-on-demand systems: A deep reinforcement learning approach [16] **Zhengfei Zheng*, Peibo Duan, Zheng Liang & Hai Yang**

Bridging boundaries: Understanding infrastructure governance in the context of land use and transport integration [108] **Rafsana Hossain*, Liton Kamruzzaman, Elizabeth Taylor & Tooran Alizadeh**

PROGRAM

Friday 29 November

12.40pm – 2.00pm
Auditorium

CLOSING CEREMONY AND LUNCH
Chair: Assoc Prof Alexa Delbosch, Monash University

ATRF President Speech
Prof Graham Currie, Monash University

Awards presentation
Handover to ATRF 2025 Host
Farewell lunch

3.00pm – 5.00pm
Room 841

FREE PUBLIC EVENT
High-speed rail + Urban design: The ingredients of a successful plan
Moderator: Dr Ian Woodcock, University of Sydney

Speakers:
Alice Vialard, University of Sydney
Benish Chaudhury, Department of Transport and Planning/University of Melbourne
Ross Lowrey, Fastrack Australia
Iain Lawrie, MVC Services/University of Melbourne
James Whitten, Monash University

PROGRAM